

CFM-L220

The CFM-L220 product line is custom designed to match the airflow need of small size car without air conditioning system. The system is optimized for weight.

It is extensively tested for the severe engine bay working condition and its reliability is proved by millions of applications world-wide.

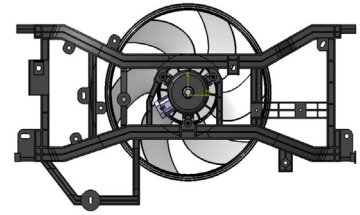

Technology Leadership

- Low weight for fuel economy and reduced emissions
- Low noise and vibration
- High efficiency

Performance Range

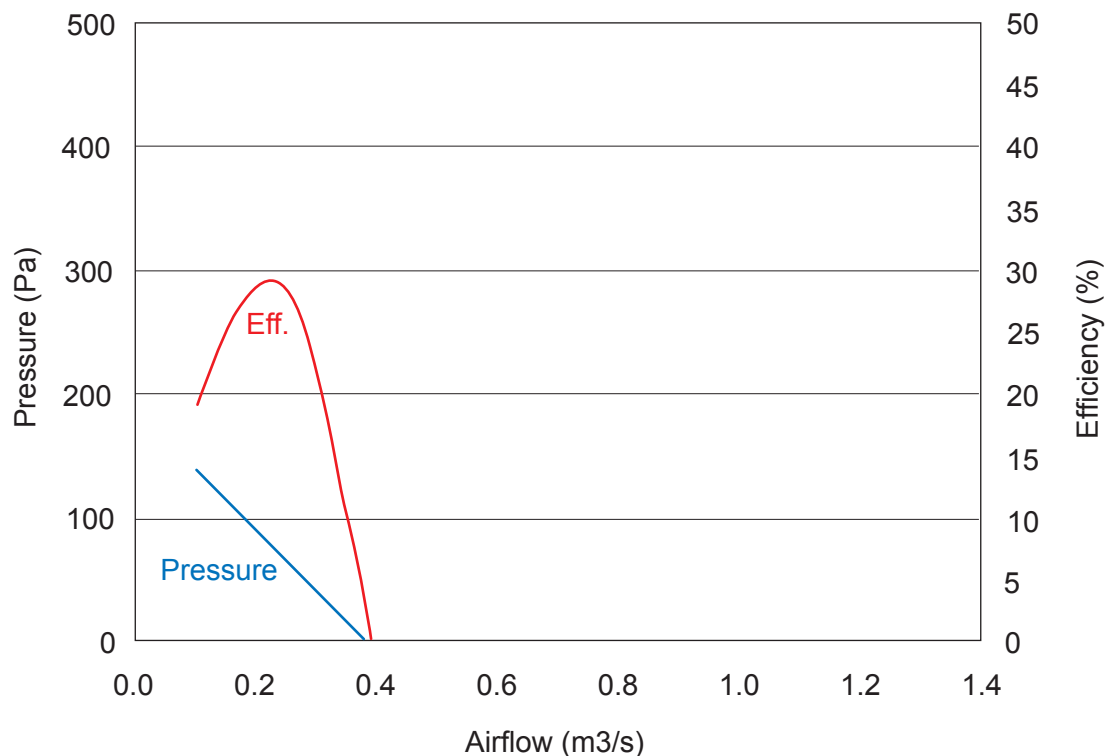

CFM-L220

Specification

■ Airflow power	: 20 W (*)
■ Axial length	: 106 mm (*)
■ Weight	: 1.40 kg (*)
■ Efficiency	: 25 % (*)
■ Fan Diameter	: 270 mm (*)
■ Supply	: 9 to 16 V
■ Temperature	: - 40°C to + 110°C (peak 125°C)
■ Absorbed power	: 80 W
■ Life	: 2,000 hours (**)
■ EMC	: according to CISPR 25
■ Compliance	: ELV 2000/53/CE

(*) GATE cooling fans are designed to meet customer requirements on airflow power, axial length, weight and efficiency.

(**) Life depends on customer mission profile

Customized to your needs

- Fan is designed to meet the lowest weight and minimum noise
- Shroud can interface with any vehicle radiators and auxiliary components
- Motor is customized from a portfolio of 2 poles brushed DC technologies
- Integrated connector and flying leads
- Closed and open motor frame design