

## CFM-L250

The CFM-L250 product line is custom designed to match the airflow need of small size car without air conditioning system. The system is optimized for power density, weight and efficiency.

It is extensively tested for the severe engine bay working condition and its reliability is proved by millions of applications world-wide.

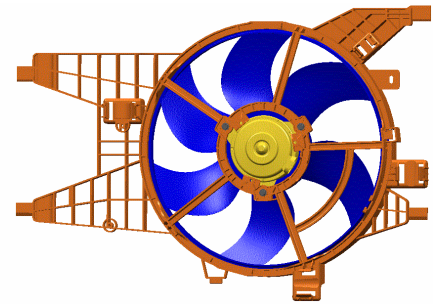

## Technology Leadership

- High power density
- Low weight for fuel economy and reduced emissions
- Low noise and vibration
- High efficiency

## Performance Range

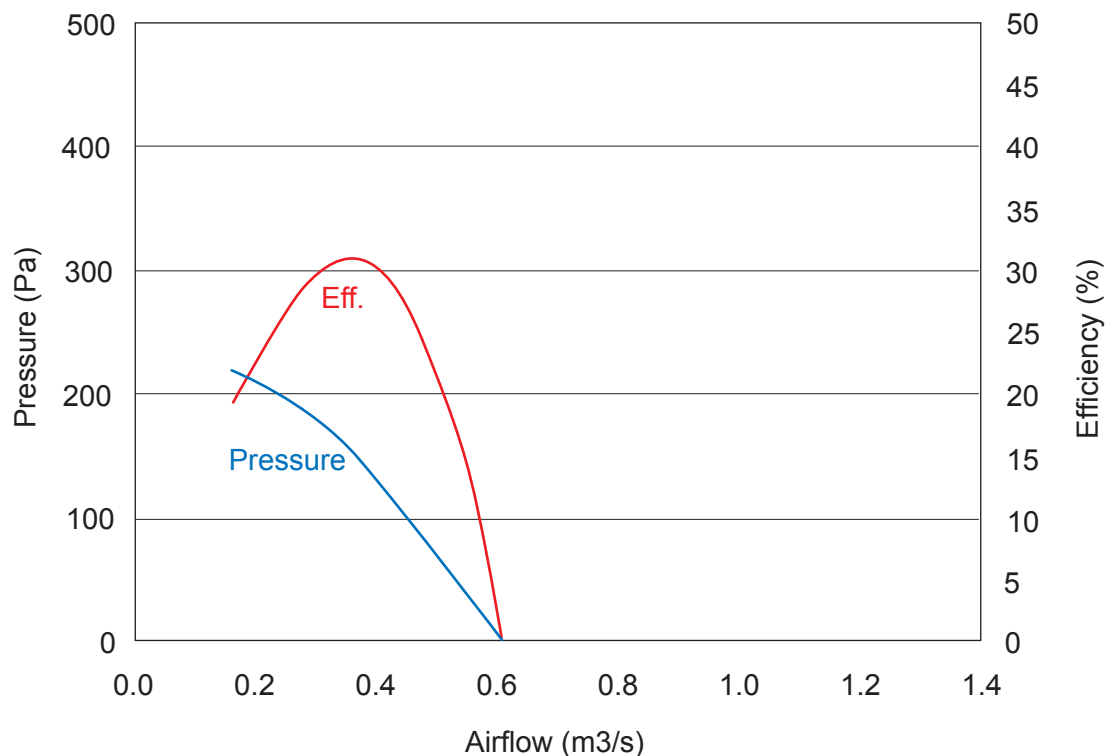

## CFM-L250

### Specification

---

■ Airflow power	: 50 W (*)
■ Axial length	: 99 mm (*)
■ Weight	: 2.08 kg (*)
■ Efficiency	: 28 % (*)
■ Fan Diameter	: 330 mm (*)
■ Supply	: 9 to 16 V
■ Temperature	: - 40°C to + 110°C (peak 125°C)
■ Absorbed power	: 180 W
■ Life	: 2,000 hours (**)
■ EMC	: according to CISPR 25
■ Compliance	: ELV 2000/53/CE

(\*) GATE cooling fans are designed to meet customer requirements on airflow power, axial length, weight and efficiency.

(\*\*) Life depends on customer mission profile

### Customized to your needs

---

- Fan is designed to meet the maximum efficiency and minimum noise
- Shroud can interface with any vehicle radiators and auxiliary components
- Motor is customized from a portfolio of 2 poles brushed DC technologies
- Integrated connector and flying leads
- Closed and open motor frame design
- Speed regulation available with resistor