

Characteristics:

150W output power, high efficiency

Specifications:

Dimensions	: Ø 2.0 X 3.3 in
Shaft Diameter	: Ø 0.250 in
Input Voltage	: 240.0 V DC
Rectified	: Rectified
No Load Speed	: 14800 rpm
Maximum Efficiency	: 69%
Speed at Maximum Efficiency	: 11300 rpm
Life (Typical)	: 600 hr
Life Test Condition	: Rectified input with E-capacitor
Weight	: 20 oz
Operating Temperature Range	: 32 to 104 °F
Storage Temperature Range	: -4 to 185 °F
Electrical Connection	: Terminal



Performance Data:

	No Load	Stall	Maximum Efficiency	Maximum Power
Current (A)	0.75	-	2.50	-
Efficiency (%)	-	-	69	-
Output Power (hp)	-	-	0.30	-
Speed (rpm)	14800	-	11300	-
Torque (Lb.in)	-	-	1.55	-

Application Examples:

Brush Roll and Power Brushes

Outline Drawing:

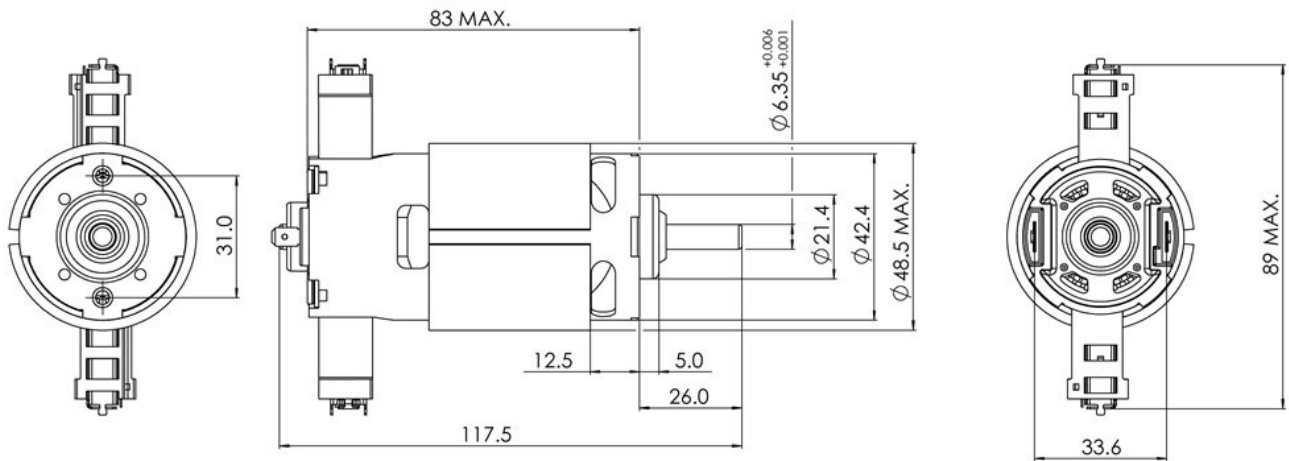

Performance Curves:

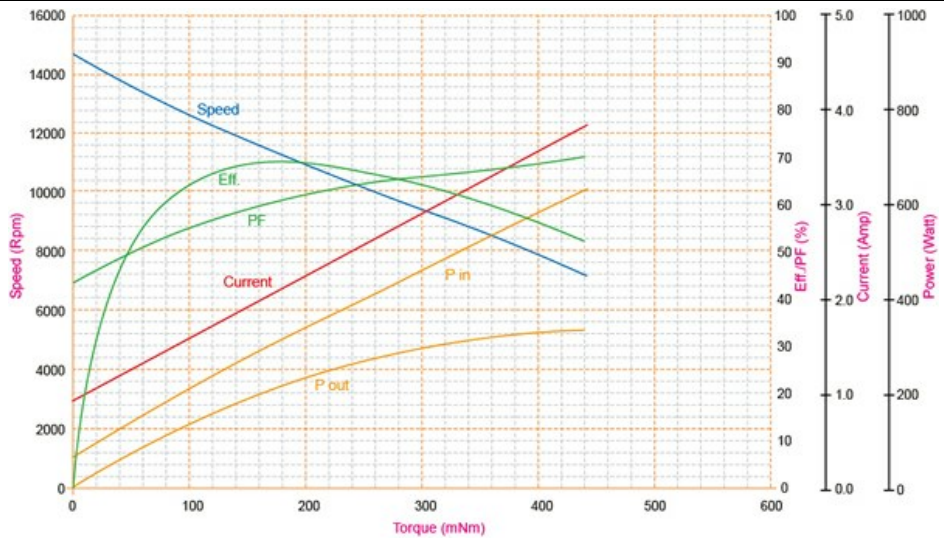

Units in Metric