

Characteristics:

150W output power, high efficiency

Specifications:

Dimensions	: Ø 48.5 X 83.0 mm
Shaft Diameter	: Ø 6.350 mm
Input Voltage	: 240.0 V DC
Rectified	: Rectified
No Load Speed	: 14800 rpm
Maximum Efficiency	: 69%
Torque at Maximum Efficiency	: 175.00 mNm
Speed at Maximum Efficiency	: 11300 rpm
Life (Typical)	: 600 hr
Life Test Condition	: Rectified input with E-capacitor
Weight	: 565 g
Operating Temperature Range	: 0 to 40 °C
Storage Temperature Range	: -20 to 85 °C
Electrical Connection	: Terminal



Performance Data:

	No Load	Stall	Maximum Efficiency	Maximum Power
Current (A)	0.75	-	2.50	-
Efficiency (%)	-	-	69	-
Output Power (W)	-	-	220.00	-
Speed (rpm)	14800	-	11300	-
Torque (mNm)	-	-	175.00	-

Application Examples:

Brush Roll and Power Brushes

Outline Drawing:

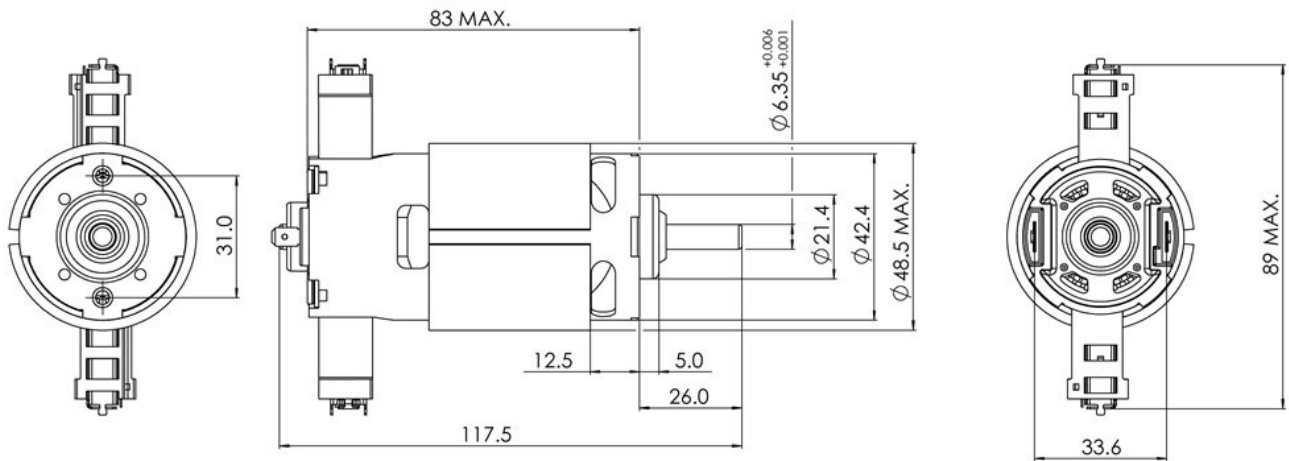

Performance Curves:

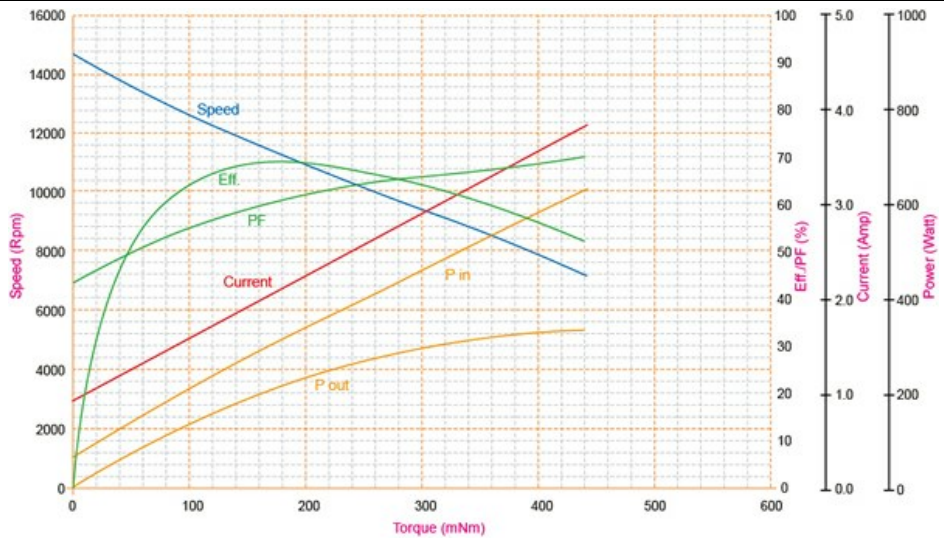

Units in Metric