

133 mm Metal Forward Centrifugal Fan

Specification:

Material:	Impeller: Metal Rotor: Zinc Plating Steel Electronics housing: Die-cast aluminium
Number of blades:	36
Direction of rotation:	Counter Clockwise viewed toward rotor
Insulation class:	"B"
Installation position:	Any
Degree of protection:	IP54
Condensation drainage holes:	None
Mode:	Continuous operation (S1)
Mounting:	Maintenance-free ball bearings
Technical features:	Controller input PWM/0-10V
Cable exit:	Variable
Protection class:	I (with customer connection of protective earth)
Conformity with standards:	UL
Weight:	1.34KG



Performance:

Nominal data	Platform	Curve	Nominal voltage range	Frequency	Speed*	Max input power*	Max input current*	Operating ambient temp	Life time	PWM/ 0-10V
Type	Motor		VAC	Hz	rpm	W	A	°C	Hr	
ECO133DF126072212 ECO133DF126072210	OD72	A	120	50 / 60	2710	120	1.64	-20 to +60	40,000	●

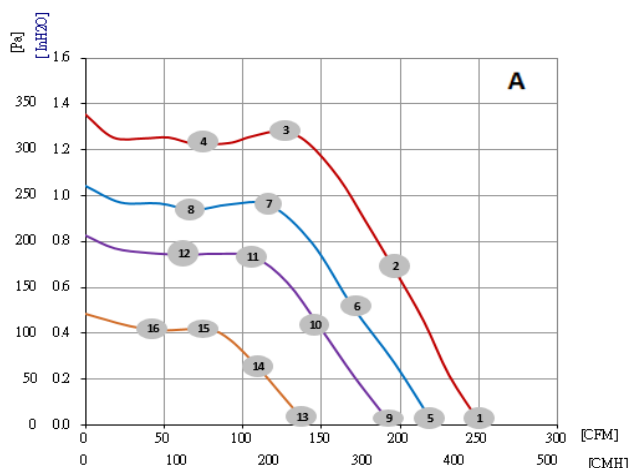

	n (rpm)	P1 (W)	I (A)	η (%)	P (Pa)	P (InH ₂ O)	Q (CMH)	Q (CFM)
①	2710	121	1.64	—	0	0	427	252
②	2710	86	1.22	17.9	166	0.67	335	197
③	2710	52	0.79	36.1	319	1.28	213	126
④	2710	35	0.55	28.7	305	1.22	119	70
⑤	2390	82	1.16	—	0	0	375	221
⑥	2390	58	0.87	17.6	128	0.52	288	170
⑦	2390	40	0.63	32.9	239	0.96	199	117
⑧	2390	27	0.45	28.6	234	0.94	117	69
⑨	2120	57	0.85	—	0	0	330	194
⑩	2120	42	0.65	17.9	107	0.43	252	148
⑪	2120	30	0.49	30.7	182	0.73	181	107
⑫	2120	20	0.35	27.6	184	0.74	109	64
⑬	1580	25	0.4	—	0	0	240	141
⑭	1580	19	0.33	16.7	62	0.25	186	110
⑮	1580	15	0.26	26.3	104	0.42	133	78
⑯	1580	11	0.2	20.5	102	0.41	80	47

133 mm Metal Forward Centrifugal Fan

Drawing:

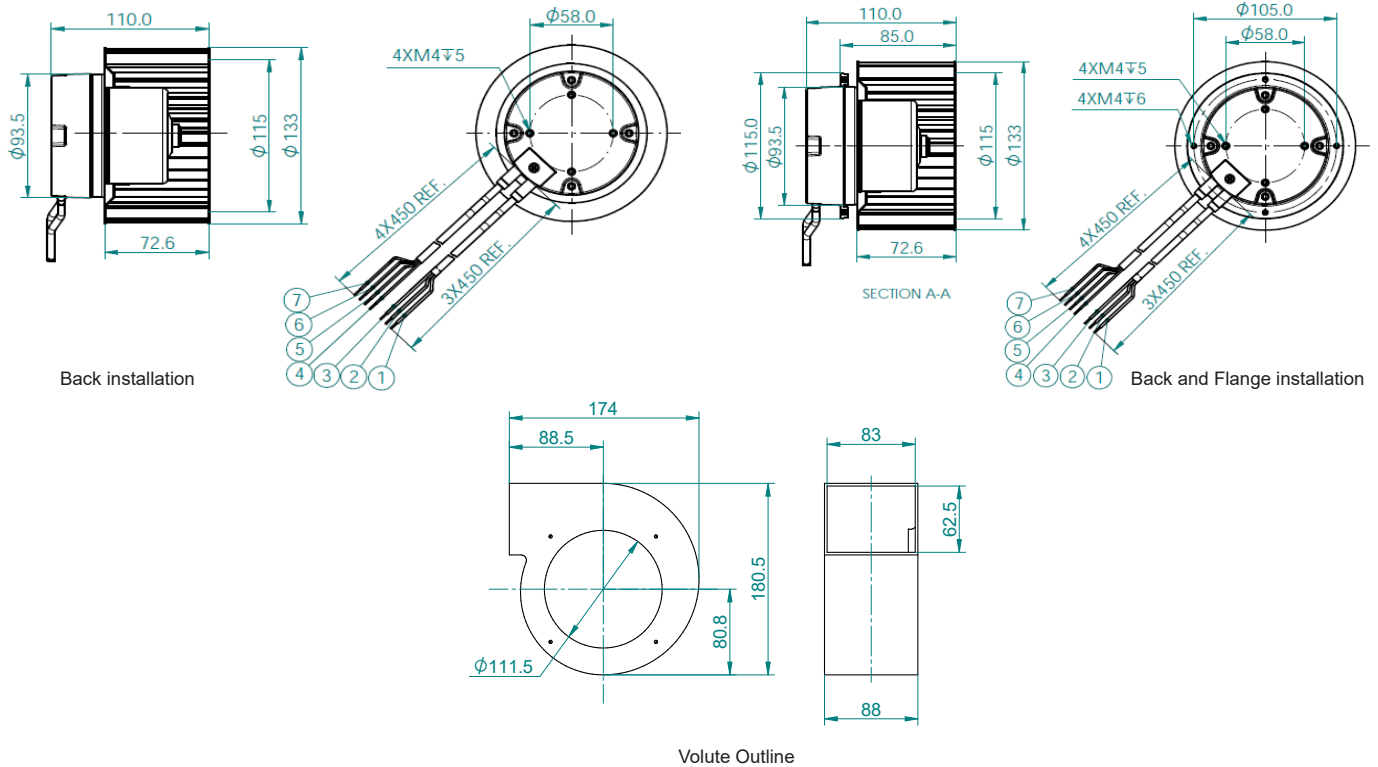
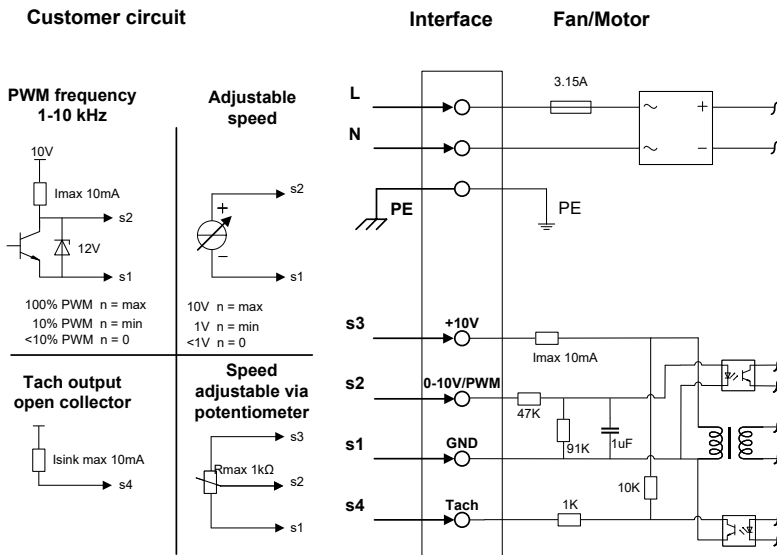

Diagram:



No.	DESIGNATION	COLOR	ASSIGNMENT
1	L	BROWN	POWER SUPPLY
2	N	BLUE	NEUTRAL
3	PE	GREEN/YELLOW	GROUND CONNECTION
4	GND	BLACK	GND CONNECTION FOR CONTROL INTERFACE, SELV
5	PWM/0-10V	YELLOW	CONTROL INPUT PWM/0-10V, SELV
6	TACH	WHITE	TACH OUT, SELV
7	+10V	RED	VOLTAGE OUTPUT 10 VDC, SELV