

190mm Plastic Backward Centrifugal Fan

SPECIFICATIONS

- Material: Impeller: Plastic
Rotor: Zinc Plating Steel
Electronics housing: Die-cast aluminium
- Number of blades: 7
- Direction of rotation: Clockwise viewed toward rotor
- Insulation class: "B"
- Installation position: Any
- Degree of protection: IP54
- Condensation drainage holes: None
- Mode: Continuous operation (S1)
- Mounting: Maintenance-free ball bearings
- Technical features: Controller input PWM/0-10V
- Cable exit: Variable
- Protection class: I (with customer connection of protective earth)
- Conformity with standards: EN 60335-1/UL
- Weight: 1.4KG



PERFORMANCE

Nominal data	Platform	Nominal voltage range	Frequency	Speed*	Max input power*	Max input current*	Operating ambient temp	Life time	Curve	PWM/ 0-10V
Type	Motor Code	VAC	Hz	rpm	W	A	°C	Hr		
ECO190CB126072210	ECO-072-025-126-PA-210	120	50 / 60	3670	130	1.78	-20 to +60	40,000	A	●
ECO190CB126072212										
ECO190CB235072210	ECO-072-025-235-PA-210	230				1.05			B	
ECO190CB235072212										

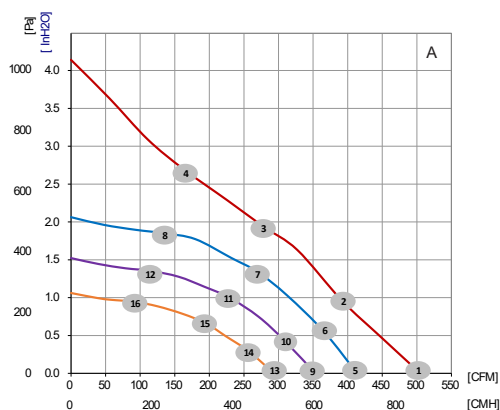

	n (rpm)	P1 (W)	I (A)	η (%)	P (Pa)	P (inH ₂ O)	Q (CMH)	Q (CFM)
①	3960	134	1.78	—	0	0	850	501
②	3680	135	1.78	32.6	240	0.96	666	392
③	3670	136	1.78	46.6	481	1.93	474	279
④	3850	136	1.78	38.0	670	2.69	277	163
⑤	3210	75	1.06	—	0	0	702	414
⑥	3210	89	1.22	26.3	136	0.55	622	366
⑦	3210	93	1.27	45.8	334	1.34	458	270
⑧	3210	81	1.13	35.9	461	1.85	229	135
⑨	2760	50	0.74	—	0	0	601	354
⑩	2760	58	0.85	27.2	110	0.44	523	308
⑪	2760	61	0.88	43.9	249	1.00	389	229
⑫	2760	54	0.78	34.0	338	1.36	195	115
⑬	2290	32	0.49	—	0	0	497	293
⑭	2290	37	0.56	24.0	74	0.30	435	256
⑮	2290	38	0.58	40.1	165	0.66	331	195
⑯	2290	33	0.52	30.4	236	0.95	155	91

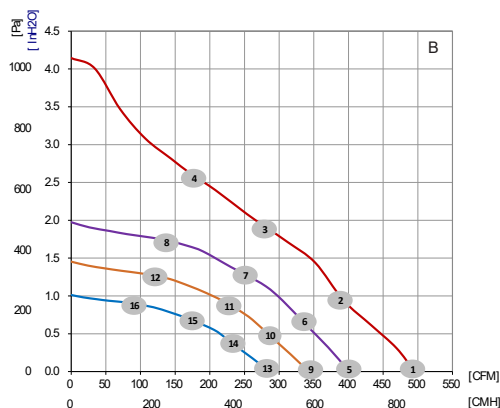

	n (rpm)	P1 (W)	I (A)	η (%)	P (Pa)	P (inH ₂ O)	Q (CMH)	Q (CFM)
①	3930	131	1.04	—	0	0	850	501
②	3670	132	1.05	32.8	235	0.94	667	393
③	3670	131	1.05	47.8	477	1.92	475	280
④	3800	131	1.05	40.1	652	2.62	292	172
⑤	3120	65	0.55	—	0	0	681	401
⑥	3120	78	0.65	32	157	0.63	573	337
⑦	3120	79	0.65	47.8	320	1.28	426	251
⑧	3120	71	0.60	40	430	1.73	239	141
⑨	2680	44	0.39	—	0	0	581	342
⑩	2680	52	0.45	29.7	113	0.45	491	289
⑪	2680	53	0.45	45.4	226	0.91	382	225
⑫	2680	48	0.42	37.4	315	1.26	206	121
⑬	2250	28	0.26	—	0	0	485	286
⑭	2250	33	0.3	28.7	84	0.34	403	237
⑮	2250	33	0.3	42	168	0.67	299	176
⑯	2250	30	0.28	33	222	0.89	159	94

DRAWING

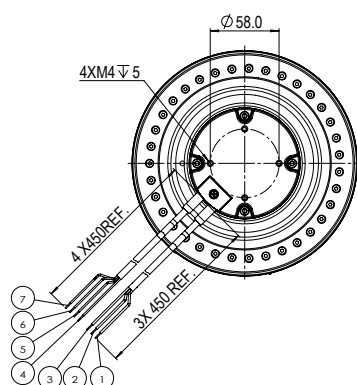
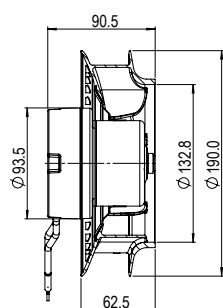

ECO190CB126072210
ECO190CB235072210

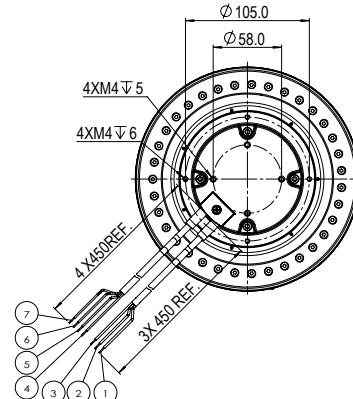
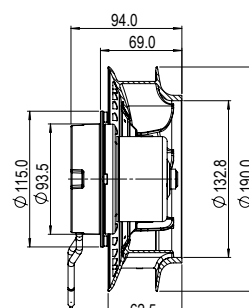

ECO190CB126072212
ECO190CB235072212

DIAGRAM

Customer circuit

PWM frequency 1-10 kHz

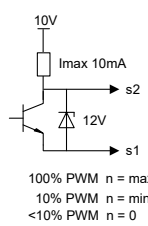

Tach output open collector

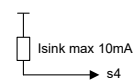

Adjustable speed

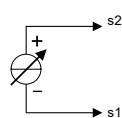

Speed adjustable via potentiometer

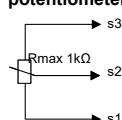

Interface

Fan/Motor

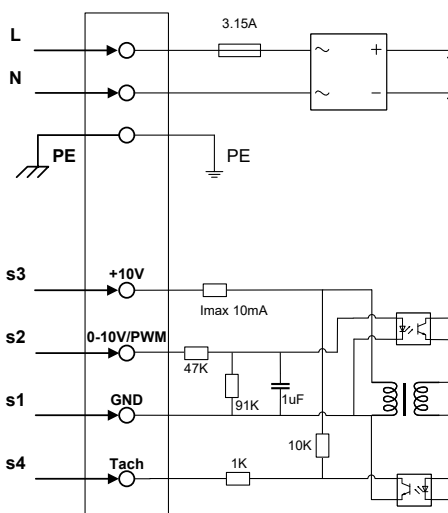

NO.	DESIGNATION	COLOR	ASSIGNMENT
1	L	BROWN	POWER SUPPLY
2	N	BLUE	NEUTRAL
3	PE	GREEN/YELLOW	PROTECTIVE EARTH
4	GND	BLACK	GND CONNECTION FOR CONTROL INTERFACE, SELV
5	PWM/0-10V	YELLOW	CONTROL INPUT PWM/0-10V, SELV
6	TACHO	WHITE	TACHO OUT, 1 PULSE/REVOLUTION, SELV
7	+10V	RED	VOLTAGE OUTPUT 10 VDC, SELV